



# ***BAGGRIPPER***

Heavy Duty - High Capacity  
Bag Opener



# BAGRIPPER

## 2600 S



The Rentec BagRipper is an extremely robust and high-performance plastic-bag-opener, suitable for a wide range of materials, e.g. light packaging material, residual waste, household waste, wastepaper.

The Rentec BagRipper relies on a unique RIPPER concept. Separately adjustable differential speeds between the rotors ensure that virtually 100 % of bags (-in-bags) are opened.

The rotors are equipped with solid, abrasion and shockproof steel profiled toothing. Cleaning fingers prevent entanglement and wrapping of strings, tapes, wires and foils. They are attached by bolts to the side walls of the ripper table for easy removal.

This Rentec RIPPER concept is a revolutionary approach, characterized by :

- a NATURAL, power-efficient ripping of the waste bags  
⇒ less installed power, less energy consumption
- the absence of TRANSVERSE COUNTER-KNIVES UNDER THE ROTORS  
⇒ no building up of stripes and film over the knives under the rotors ⇒ no daily cleaning  
⇒ no "SHREDDING by CUTTING" ⇒ no damage to the content ⇒ less fines in output  
⇒ insensitive to abrasive fines (glass, sand, soil,...) ⇒ less service on wear parts
- the absence of a fixed CENTRAL MIDDLE BAR  
⇒ massive throughput capacity since bars and anvils act as obstacles for smooth passing of the material  
⇒ less service on the wear parts

The massive infeed hopper with large, ergonomic infeed opening is pre-fitted with an inspection platform and an electrically secured access door in order to safely remove foreign bodies that may occasionally stop the BagRipper.

Adjustable rotorsequences regulate the metered output flow to balance with the subsequent sorting and preparation plant capacity.

To drive the rotors of the BagRipper, Rentec relies on :

- energy efficient, dynamic and reliable electric drives for applications in light weight packaging waste (co-mingled waste, LVP, PMD, PBD, collecte sélective...)
- heavy duty hydrostatic drives for applications in mixed municipal solid waste (MSW)



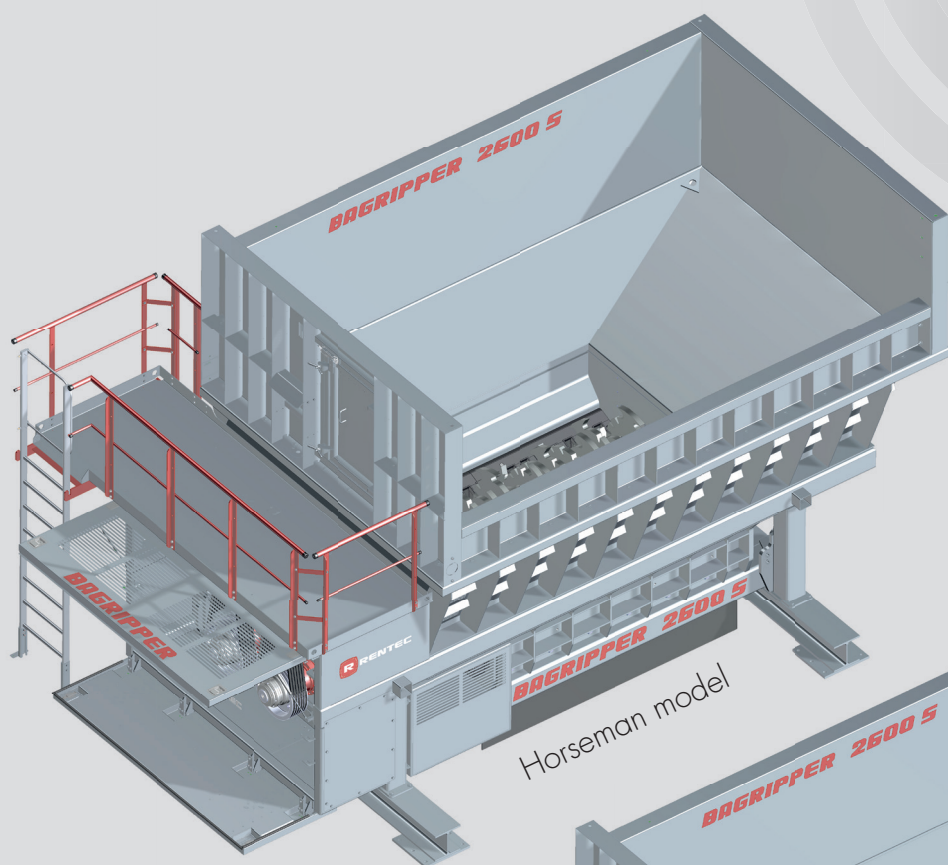

Horseman model

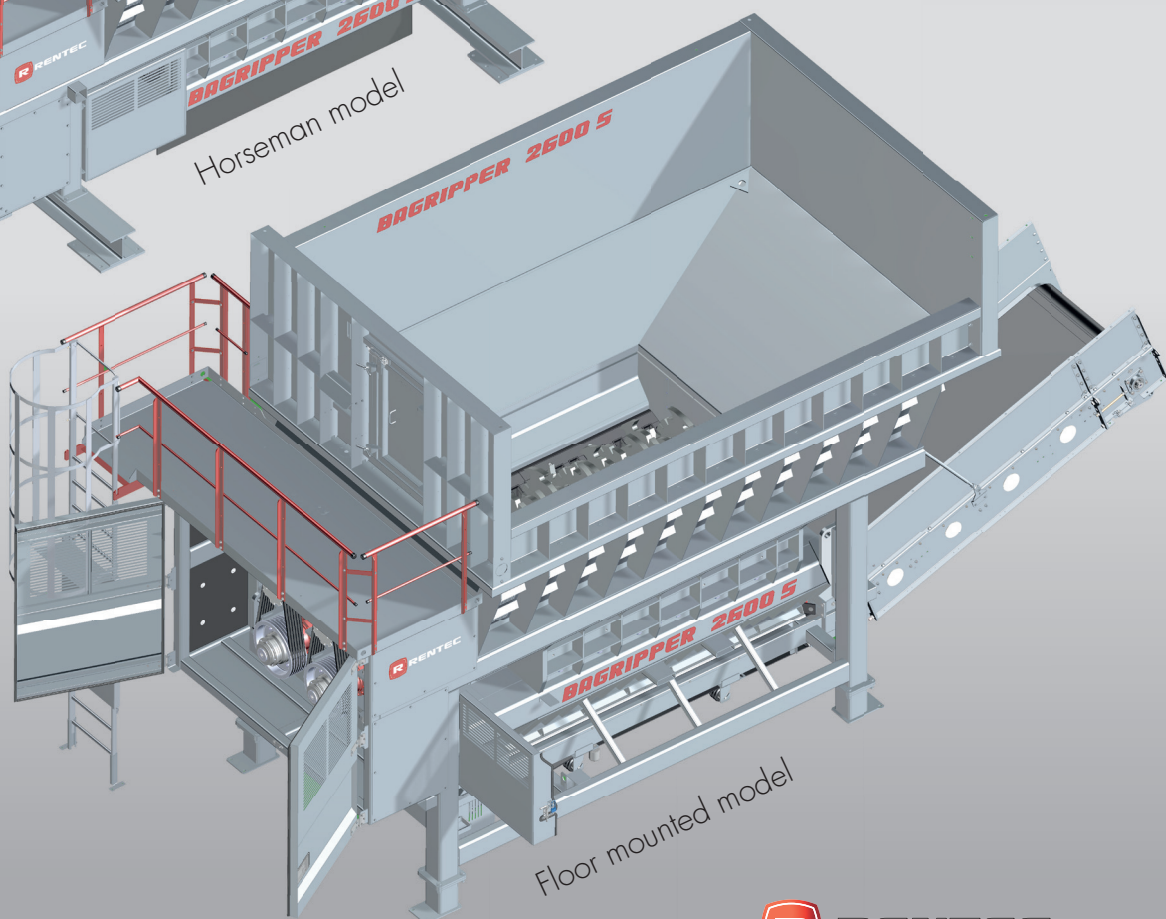

Floor mounted model

# BAGGRIPPER

## Heavy Duty - High Capacity Bag Opener



The machine is available as 'horseman' model for smooth operation with existing underfloor conveyor systems or as 'floor-mounted' model with integrated discharge conveyor.

### HORSEMAN model

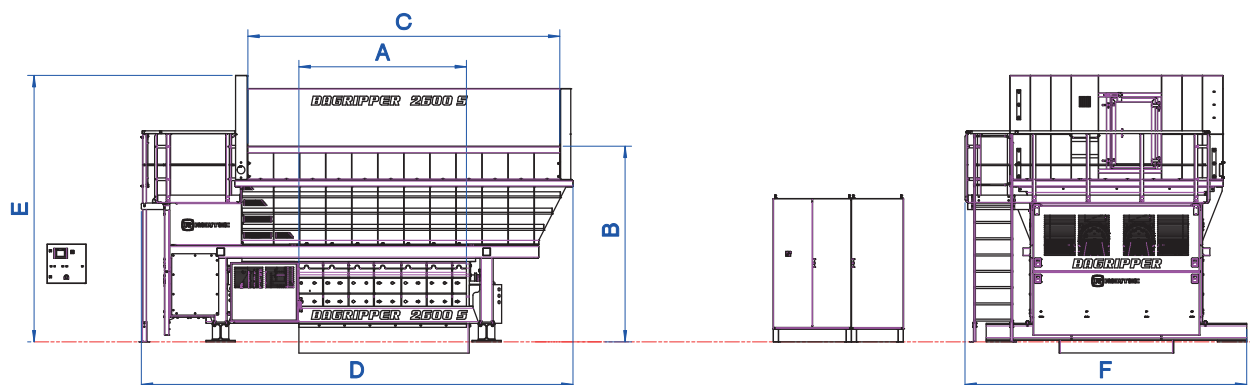

### FLOOR MOUNTED model

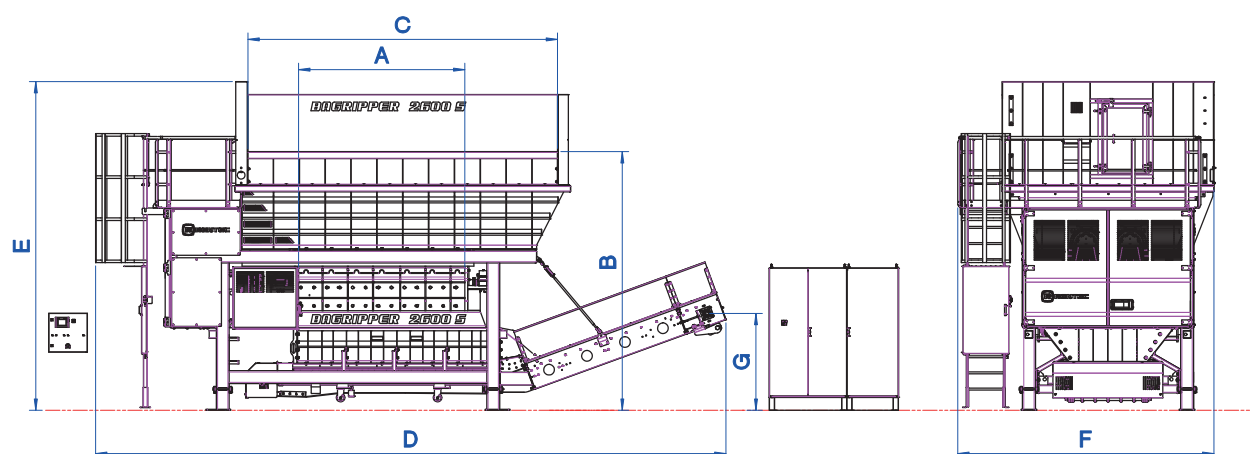

#### BAGGRIPPER 2600 S

#### HORSEMAN model

#### FLOOR MOUNTED model

#### SPECIFICATIONS

Number of rotors	2	2
Length of rotor (A)	2.600 mm	2.600 mm
Loading height (B)	3.000 mm	4.000 mm
Loading opening (C)	4.800 mm	4.800 mm
Infeed hopper volume	17 m <sup>3</sup>	17 m <sup>3</sup>
Overall machine length (D)	6.650 mm	9.750 mm
Overall machine height (E)	4.090 mm	5.090 mm
Overall machine width (F)	4.325 mm	3.965 mm
Discharge height conveyor (G)	/	1.450 mm
Drive system	frequency controlled electric motors	frequency controlled electric motors
Installed power	2 x 55 kW	2 x 55 kW
Throughput rate	up to 400 m <sup>3</sup> /hour	up to 400 m <sup>3</sup> /hour
Machine weight	approx. 30 T	approx. 34 T